

Andover Supercross

Technical Guide

Round 11 (postponed round 8) of The South Downs Social Wessex Cyclocross League



- Date: Sunday 7th January 2024
- Entries: www.AndoverSupercross.co.uk
(entry on the day available - cash or cards taken)
- Venue: Charlton Sports and Leisure Centre, Andover SP10 3LF
- Organiser: Dr Alex Forrester, 07723 337002, alex@howtorideabike.co.uk
- Commissaire panel: Ian Macdonald, Charlie Elsey and David Kahn
- Commentator: Vin Cox
- Medical Team: Collingwood Services Ltd
- Nearest Hospital: Royal Hampshire County Hospital, Romsey Road , Winchester,
Hampshire, SO22 5DG Phone: 01962863535
- Nearest Hotels: Premier Inn (1 mile)
West Portway Industrial Estate, Joule Rd, Andover SP10 3UX
Phone: 0333 777 3664
Travel Lodge (1 mile)
Business Park, Hawker Siddeley Way, Andover SP11 8BF
Phone: 0871 559 1895

Event Timetable

Friday 5th January	Course build - volunteers welcome!
Saturday 6th January	Course build - volunteers welcome!
Sunday 7th January	
08:00 - 14:30	Rider registration open (closes for each race 15 minutes before the start)
08:30 - 09:10	Official training
09:10 (10 mins)	Under 8s (podiums 10:15)
09:30 (10 mins)	Under 10s (podiums 10:15)
09:50 (15 mins)	Under 12s (podiums 10:15)
10:10 - 10:35	Official training
10:35 (30 mins)	Youth U16 (podiums 11:15)
10:36 (30 mins)	Youth U14 (podiums 11:15)
11:10 - 11:15	Official training
11:20 (40 mins)	Open Vet 40 & Junior (podiums 12:10)
12:10 - 12:25	Official training
12:30 (40 mins)	Women Elite, U23, Vets & Junior (podiums 13:25)
13:20 - 13:40	Official training
13:45 (40 mins)	Open Vet 50 (podiums 14:40)
14:45 (60 mins)	Open Elite & U23 (podiums 15:55)
Monday 8th January	Course takedown - volunteers welcome!

Directions

Charlton Sports and Leisure Centre is not far off the A303 to the west of Andover on the edge of the Portway Industrial Estate. The above postcode SP10 3LF is not quite where the event is but it will get you to within the perimeter of our signs!

What3Words: <https://w3w.co/timing.saves.whirlwind>

Parking

There is parking next to the course on asphalt and hard-standing, overflow parking next door at Andover FC, and additional parking available along the roads of the industrial estate adjacent to the course. The upper car park is quite small and has car-sized spaces marked. **We are therefore kindly asking those with vans not to use this carpark. Please follow directions of marshalls.**

Race Results

Live results will be available on the day and will be posted on <https://my.raceresult.com/273425/> after the event.

Course - 2 540 metres (100 000 inches)

A classic cyclocross blend of road, flat grass, steep banks, tracks, sand, plus a bit of BMX track! Please see map below and go to www.AndoverSupercross.co.uk for a video of previous year's courses.

Pits

There is a spacious double pit with a tarmac surface. Please take note of the pit layout during your sighting lap(s) and take extra care with your bike changes on the tarmac. The bike wash area, with a water tap, is immediately adjacent to the pits.

Sweeper

After the winner of each race crosses the line, a 'sweeper' will ride the course at a respectful distance behind the last rider on the course. Do not practise on the course until the sweeper has passed and do not overtake the sweeper.

Photos

Check out the Wessex League Facebook page and www.pitchsidephoto.co.uk after the event for photos of the racing.

Event Village & Gazebos

There will be chips & coffee vans and Big Bobble Hats near the pits, plus a cake stall (raising money for Charlie's loggerhead turtle conservation trip). Clubs can pitch gazebos on the grass near the start (see course map below). Please leave enough room for the rider call-up area.

Registration

Sign-on is in a gazebo near the finish line. You need to sign on first, before going to get a chip from the chip timing tent. Make sure you have signed on no later than 15 minutes before your race starts. If you are pre-registered with the league, please remember your number. All other riders will need to pick up a new number that should be returned to the sign-on desk after the race. If you are entering on the day, please remember to bring your racing licence (if you have one). A day licence can be purchased at registration for £3. U10, U12, U14 and U16 riders do not require a licence.

BMX Taster sessions

There will be free BMX taster sessions at the BMX track from 09:00. Bikes, helmets and expert, qualified coaching will all be provided free of charge by Andover BMX Club. Many top riders have a background in BMX - give it a try!

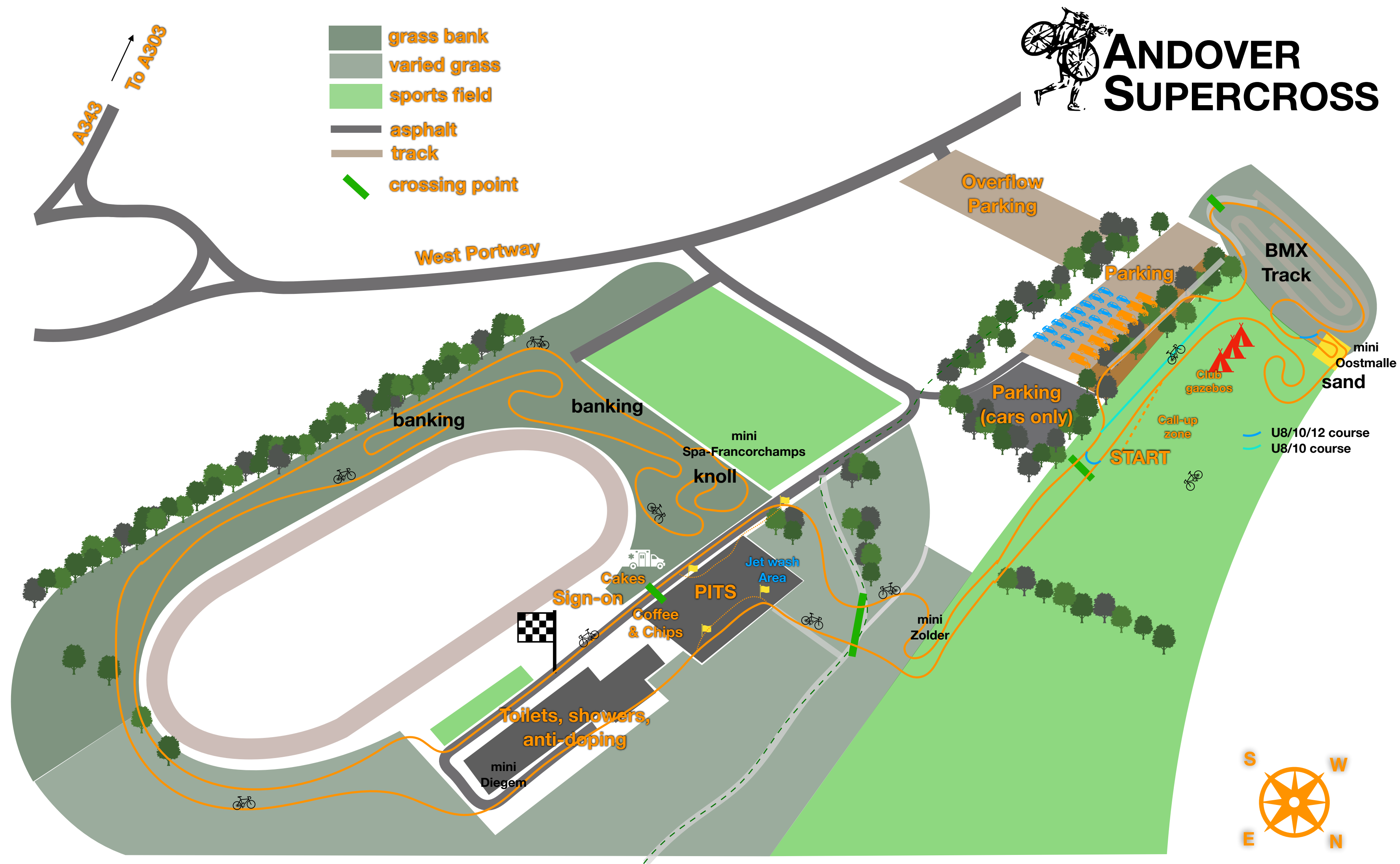

Prize list

Cash prizes will be according to the table below.

	1st	2nd	3rd
U8	Medal	Medal	Medal
U10	Medal	Medal	Medal
U12	Medal	Medal	Medal
U14	£15	£10	£5
U16	£15	£10	£5
Jun	£15	£10	£5
Sen	£15	£10	£5
V40	£15	£10	£5
V50	£15	£10	£5
V60	£15	£10	£5